

YDS-OIS-FF-OV4688 V2.0

4MP OmniVision OV4688 OIS MGS MIPI Interface Fixed Focus Camera Module



Camera Module No.	YDS-OIS-FF-OV4688 V2.0
Resolution	4MP
Image Sensor	OV4688 w/ MGS OIS
Sensor Type	1/3"
Pixel Size	2.0 um x 2.0 um
EFL	2.30 mm
F.NO	2.40
Stabilization Method	Optical Image Stabilization (OIS)
Stabilizer Type	Micro Gimbal Stabilizer (MGS)
Stabilizer Axis No.	2 Axis (Pitch and Yaw)
Stabilizer Angle	Max. 4.5°
Stabilizer Power	180 mW
Pixel	2688 x 1520
View Angle	117°(DFOV)
Lens Dimensions	19.00 x 19.00 x 9.90 mm
Module Type	Fixed Focus
Lens Barrel	M8.0 x P0.5
Interface	MIPI
Lens Type	650nm IR Cut
Operating Temperature	-30°C to +85°C
Mating Connector	BAF04-30083-0500



YDS-OIS-FF-OV4688 V2.0

4MP OmniVision OV4688 OIS MGS MIPI Interface Fixed Focus Camera Module



Top View



Side View



Bottom View

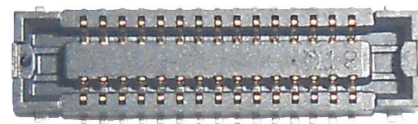

Mating Connector

RoHS

Version	Information	Date
V2.0	First Version	7-21-2023

PIN	SIGNAL
1	VCM_GND
2	VCM_GND
3	VCM_3.3V
4	SDA
5	SCL
6	MIPI_GND
7	MCN
8	MCP
9	MDN0
10	MDP0
11	MDN1
12	MDP1
13	NC
14	MDN2
15	MDP2
16	MDN3
17	MDP3
18	AGND
19	AVDD_2.8V
20	VCM_3.3V
21	DGND
22	MCLK
23	DGND
24	NC
25	PWDN(XCLR)
26	DVDD_1.2V
27	VDDIO_1.8V
28	Reset_N(GPIO)
29	ID
30	DGND

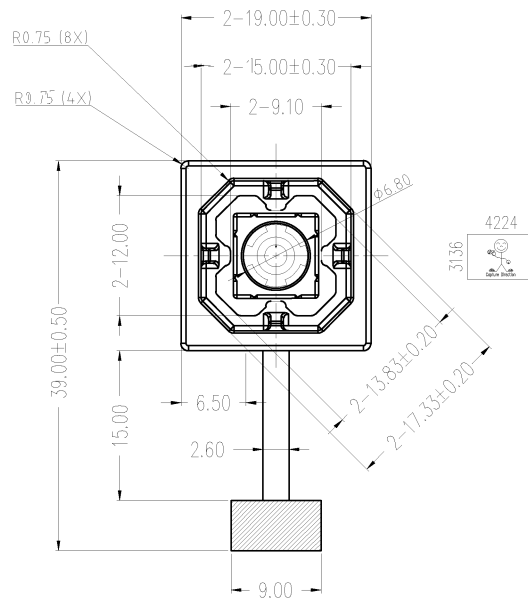

TOP VIEW

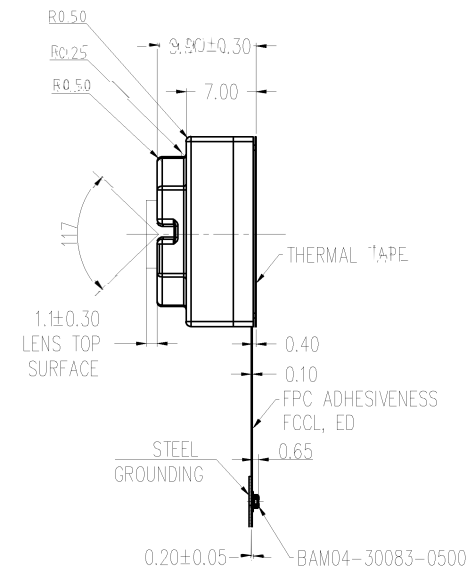

SIDE VIEW

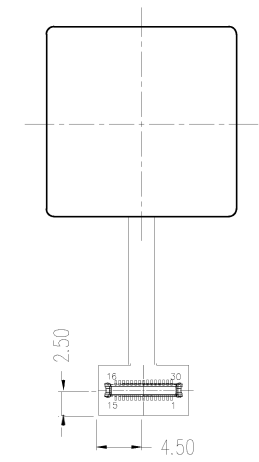

BOTTOM VIEW

Remark:

- Sensor I2C Slave Address: 0X20(W)/0X21(R) ID=1
0X6C(W)/0X6D(R) ID=0
- MGS Driver I2C Slave Address: 0X52(W)/0X53(R)
- AF Drive I2C Slave Address: 0X18(W)/0X19(R)
- VCM_3.3V: 3.3V(+/-0.05V) during operation
- AVDD_2.8V: 2.8V(+/-0.05V) during operation
- Reset_N: Connected to GPIO for the purpose of MGS ON/OFF, the pin is internal pull high, active low (MGS OFF)
- Tool0: NC, reserved

PARAMETERS PARAMETERS

Sensor Specification

Image Sensor: OV4688
 Pixel: 2.0umx2.0um
 Lens Type: 1/3"
 Important Voltage Description:
 VCM_3.3V: 3.3V
 AVDD_2.8V: 2.8V
 VDDIO_1.8V: 1.8V
 DVDD_1.2V: 1.2V

Lens Specification

FOV: 117° (DIAGONAL)
 F/NO.: 2.4±5% (INFINITE)
 TV Distortion: <-18%
 Focal Length: 2.3mm
 Composition: 6 elements, all plastic

DESIGNED BY	Kevin	MODEL NAME	●S-FF-OV4688 V2.0		
CHECKED BY	Aouly Yan	Projection Type:	Unit:	Material:	
		Third Angle	Scale: 1:1	Sheet: 1 of 1	Version: 1.0

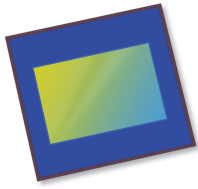

OV4688 4MP product brief



Native 16:9 HD 4-Megapixel CameraChip™ Sensor with High Frame Rate and Excellent Low Light Sensitivity for Next-Generation Video Applications



available in a lead-free package

The OV4688 is a high-performance 4-megapixel CameraChip sensor in a native 16:9 high definition (HD) format designed to deliver ultra-high quality fast frame rate HD video for mobile devices. Built on a new 2-micron OmniBSI-2™ pixel, the OV4688 offers best-in-class low-light performance with a 40 percent increase in sensitivity compared to the 1.75-micron OmniBSI-2 pixel.

The OV4688 supports timing for two High Dynamic Range (HDR) modes, frame-based sequential HDR and line-based staggered HDR. A major advantage of staggered mode over sequential mode is a significant reduction of motion artifacts in the captured images. The sensor's enhanced performance, along with its ability to record full resolution 4MP @ 90 frames per second (fps), allows it to capture best-in-class video and high-speed photography with zero shutter lag, and video HDR at 30 fps.

The 1/3-inch OV4688 can also capture 1080p HD at 120 fps with electronic image stabilization (EIS), or 720p HD at 180 fps. The OV4688's high frame rates enable additional key benefits, including full-resolution continuous frame capture or burst photography and recording of high-quality slow-motion video.

The OV4688 features a high-speed 4-lane MIPI serial output interface to facilitate the required high data transfer rate and fits into an 8.5 x 8.5 mm module with a z-height of about 5 mm.

Find out more at www.ovt.com.



Applications

- Cellular Phones
- Digital Video Camcorders (DVC)
- Digital Still Cameras (DSC)
- PC Multimedia

Product Features

- supports staggered, sequential HDR timing
- automatic black level calibration (ABLC)
- programmable controls for frame rate, mirror and flip, cropping, and windowing
- static defective pixel canceling
- supports output formats: 10-bit RAW RGB (MIPI)
- supports horizontal and vertical subsampling
- supports images sizes: 4MP, 3MP, EIS1080p, 1080p, EIS720p
- fast mode switching
- support 2x2 binning, 4x4 binning, re-sampling filter
- standard serial SCCB interface
- up to 4-lane MIPI serial output interface
- embedded 1.5K bits one-time programmable (OTP) memory for part identification, etc
- two on-chip phase lock loops (PLLs)
- programmable I/O drive capability
- built-in temperature sensor

OV4688



Ordering Information

- OV04688-G04A-Z**
(color, chip probing, 200 μ m backgrinding, reconstructed wafer with good die)

Product Specifications

- active array size:** 2688 x 1520
- max S/N ratio:** 38.3 dB
- power supply:**
 - core: 1.1 - 1.3V
 - analog: 2.6 - 3.0V
 - I/O: 1.7 - 3.0V
- power requirements:**
 - active: 163 mA (261 mW)
 - standby: 1 mA
 - XSHUTDOWN: <10 μ A
- temperature range:**
 - operating: -30°C to +85°C junction temperature
 - stable image: 0°C to +60°C junction temperature
- output formats:** 10-bit RAW RGB data
- lens size:** 1/3"
- input clock frequency:** 6 - 64 MHz
- lens chief ray angle:** 31.5° non-linear
- dynamic range:** 64.6 dB @ 1x gain
- maximum image transfer rate:**
 - 2688x1520: 90 fps
 - 1920x1080: 120 fps
 - 1280x720: 180 fps
 - 672x380: 330 fps
- sensitivity:** 1900 mV/lux-sec
- scan mode:** progressive
- maximum exposure interval:** 1548 x T_{ROW}
- pixel size:** 2 μ m x 2 μ m
- dark current:** 4 mV/sec @ 60°C junction temperature
- image area:** 5440 μ m x 3072 μ m
- die dimensions:**
 - COB: 6600 μ m x 5800 μ m

Functional Block Diagram

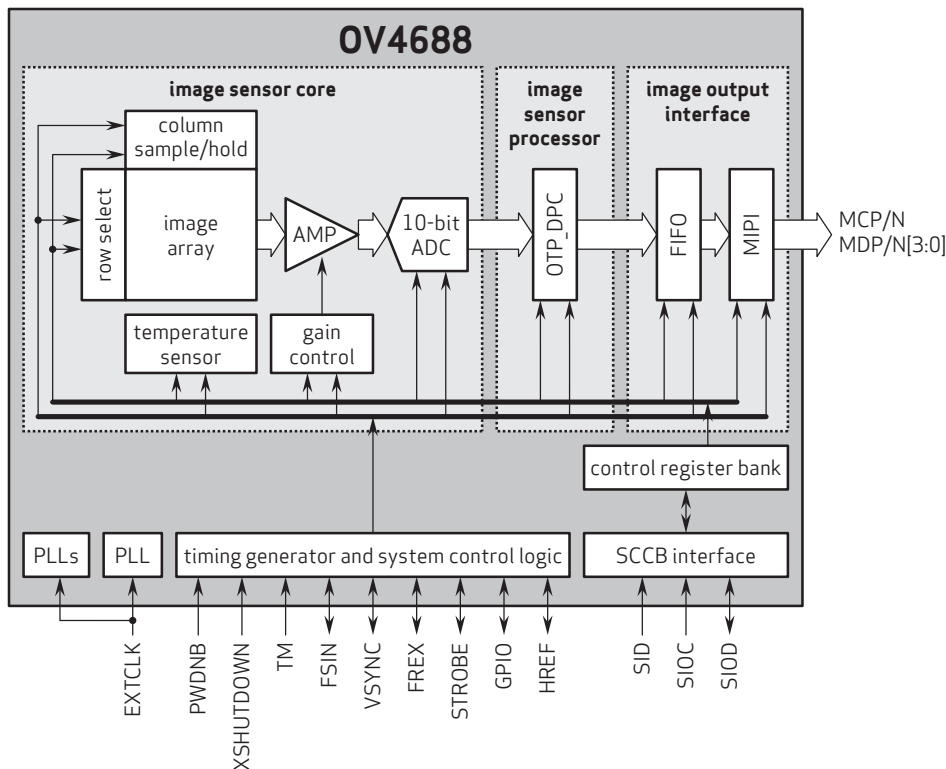

4275 Burton Drive
Santa Clara, CA 95054
USA

Tel: +1 408 567 3000
Fax: +1 408 567 3001
www.ovt.com

OmniVision reserves the right to make changes to their products or to discontinue any product or service without further notice. OmniVision and the OmniVision logo are registered trademarks of OmniVision Technologies, Inc. CameraChip and OmniBSI-2 are trademarks of OmniVision Technologies, Inc. All other trademarks are the property of their respective owners.



OmniVision

Micro Gimbal Stabilizer (MGS) OIS Camera Modules

Micro Gimbal Stabilizer (MGS) is the patented mechanical optical image stabilizer (OIS) for camera modules. The MGS technology is tilting the image sensor and lens together, enabling anti-shaking performance for moving devices to take a sharp and clear image, even in the low light environment.

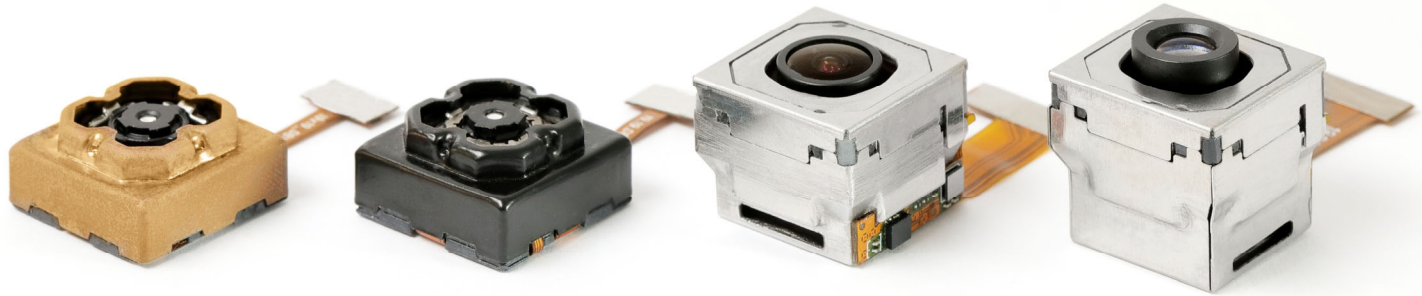

Features

2-Axis Compensation
Small, Light Weight
18.80x18.80x15.80mm



Smallest
Gimbal

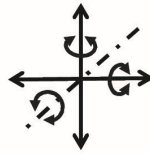

Multi-Axis
Compensation

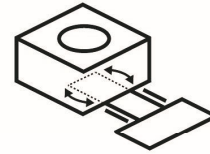

Embedded
Moving FPC



One-stop
Solution

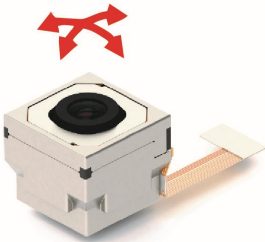

Stabilizer



Max. View Angle

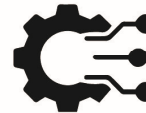

Integrated
Design



Patents

Applications



**5G Smart
Helmet**



**Sport
Camera**



Drones



Robots



**Wearable
Cameras**

Micro Gimbal Stabilizer (MGS) for Mobile Phones

Micro Gimbal Stabilizer (MGS) is fitting in the compact size, enabling the smartphones and tablet PC to take clear images in the moving environment.

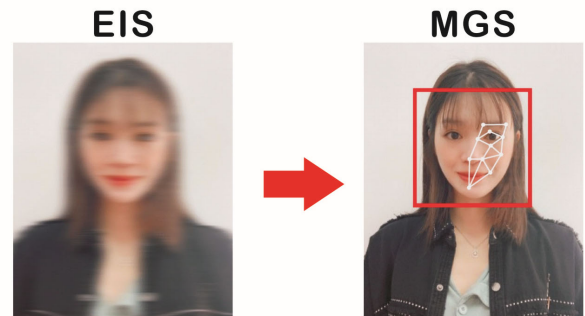
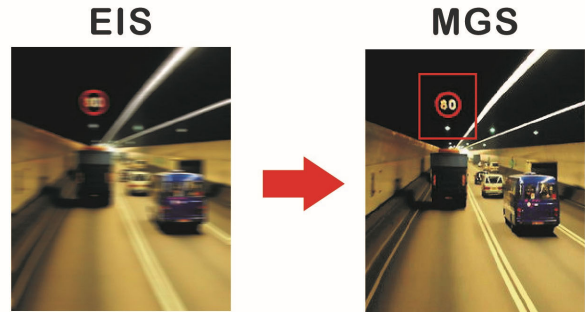
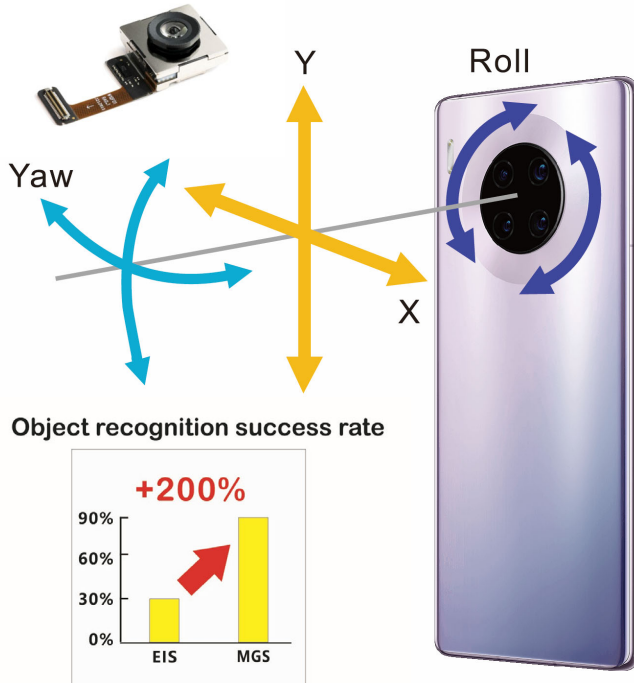

REV.	Q'TY	ECN. NO.	APR.	DATE
A	--	RC-12-2-019	Jason Su	2012.08.07

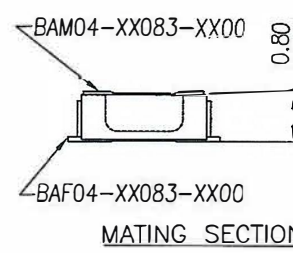
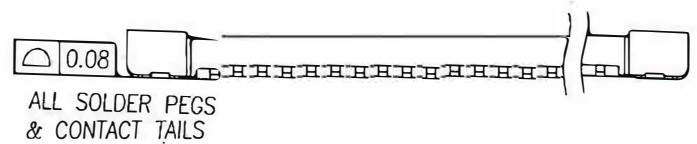
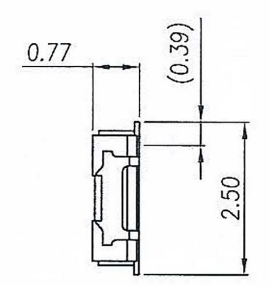
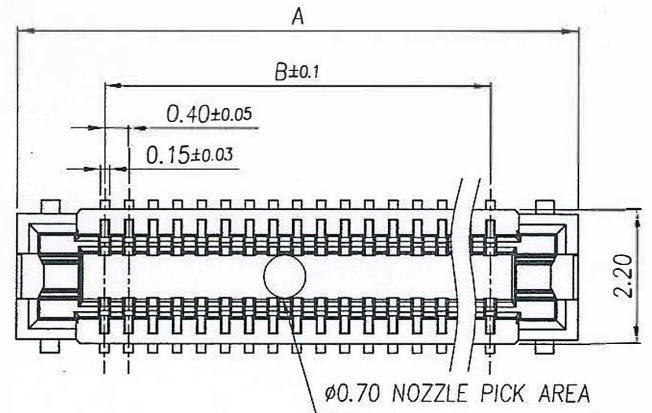

- NOTES:
- MATERIAL:
 - 1-1.HOUSING: THERMOPLASTIC,UL94 V-0,BLACK;
 - 1-2.CONTACT: COPPER ALLOY, T=0.08mm
 - FINISH:
 - 2-1.CONTACT: Au 5u" MIN PLATING ON CONTACT AREA, Au 1u" MIN. PLATING ON SOLDER TAIL, 50u" MIN. NICKEL UNDERPLATING OVER ALL
 - PRODUCT SPECIFICATIONS:
 - 3-1.VOLTAGE RATING: 60V AC/DC
 - 3-2.CURRENT RATING: 0.3A/CONTACT(MAX. 5A AT TOTAL CONTACT)
 - 3-3.INSULATION RESISTANCE: 100MEG.OHM MIN(INITIAL)
 - 3-4.WITHSTANDING VOLTAGE: 150V AC FOR 1 MINUTE
 - 3-5.CONTACT RESISTANCE: 70 MILL.OHM MAX PER PIN INITIAL, AFTER CONDITION ΔR=20 MILL.OHM Max.
 - 3-6.OPERATION TEMPERATURE: -55° TO +85°
 - 3-7.MATING FORCE: 120g Max./POS.
 - 3-8.UNMATING FORCE: 15g Min./POS.
 - 3-9.DURABILITY: 30 CYCLES

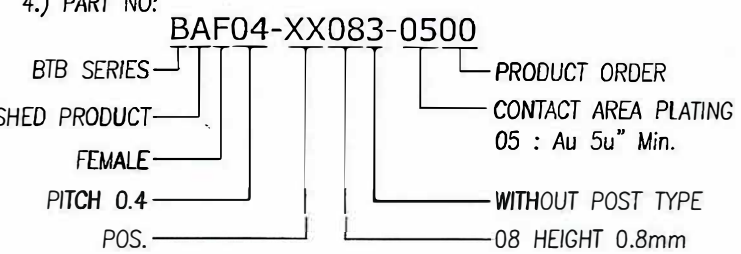
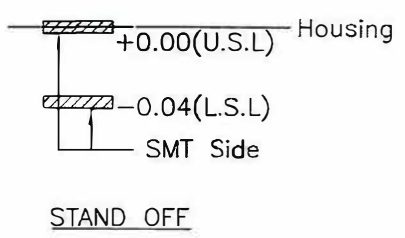
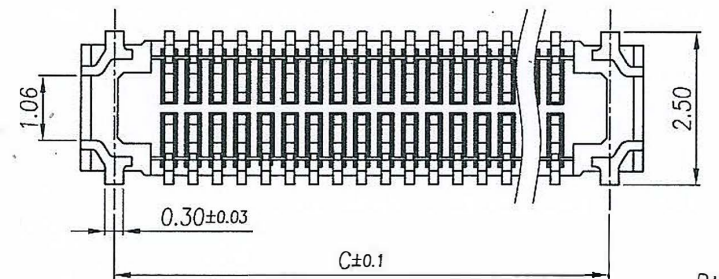
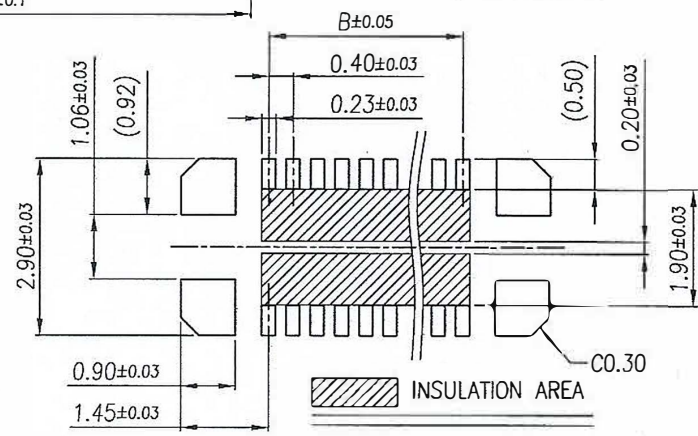

TABLE:

60	14.50	11.60	13.40	
50	12.50	9.60	11.40	
40	10.50	7.60	9.40	
34	9.30	6.40	8.20	
30	8.50	5.60	7.40	◎
26	7.70	4.80	6.60	
24	7.30	4.40	6.20	◎
20	6.50	3.60	5.40	
16	5.70	2.80	4.60	
10	4.50	1.60	3.40	◎
Pos No:	A	B	C	Available



DIMENSION IN mm			
TOLERANCE UNLESS OTHERWISE SPECIFIED			
.X± 0.35	X.*± 5°	APR.	TITLE: 0.4mm PITCH BTB FEMALE MATING HEIGHT 0.8mm
.XX± 0.25	.X*± 3°	CHK.	DWG NO. BAF04-24083-0500
.XXX± 0.15	.XX*± 1°	DRA Kevin Wang 2012.08.07	PROJ. CUSTOMER DRAWING
		SIZE A4	SCALE N/A
		SHEET 1/2	REV. A

REV.	Q'TY	ECN. NO.	APR.	DATE
A	--	RC-12-2-019	Jason Su	2012.08.07

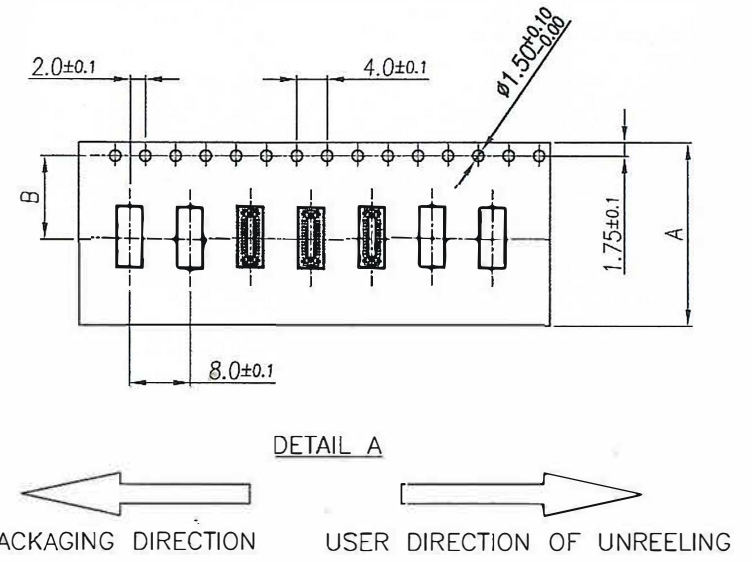
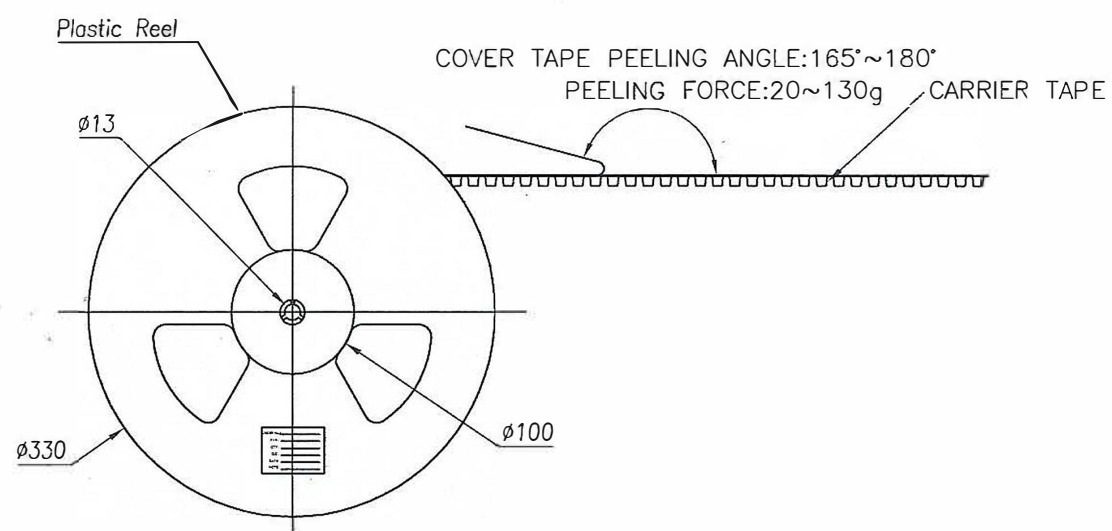
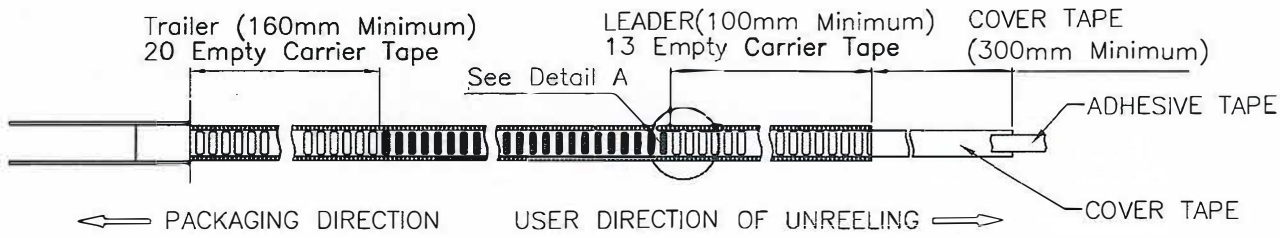

60	24.00	11.50	3000	10	30000	340*340*330
50						
40						
30						
26						
24	16.00	7.50	3000	14	42000	340*340*330
20						
16						
10						
POS NO	DIM A	DIM B	QTY/REEL	REEL/CARTON	QTY/CARTON	CARTON SIZE

DIMENSION IN mm		Shenzhen Linkconn Electronics Co.,Ltd.	
TOLERANCE UNLESS OTHERWISE SPECIFIED			
.X± 0.35	X.*± 1.5'	APR.	TITLE: 0.4mm PITCH BTB FEMALE MATING HEIGHT 0.8mm
.XX± 0.25	.X.*± 1.0'	CHK.	DWG NO. BAFO4-24083-0500
.XXX± 0.15	.XX.*± 0.5'	DRA Kevin Wang 2012.08.07	PROJ. CUSTOMER DRAWING
SIZE A4	SCALE N/A	SHEET 2/2	REV. A

Cameras Applications



Automotive Driver Pilot



Live Streaming



Video Conference



Eye Tracker Biometric Detection

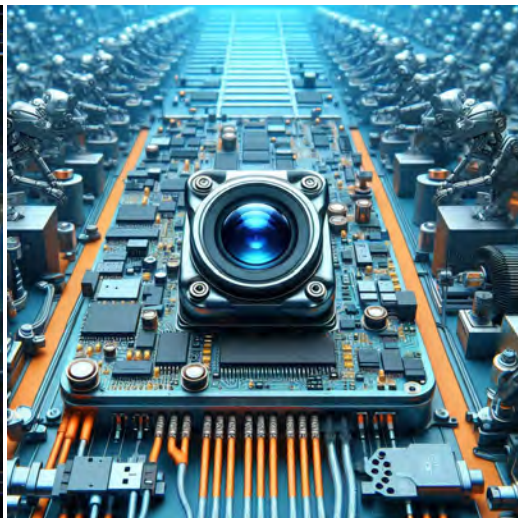

Machine Vision



Agricultural Monitor



Night Vision Security



Drone and Sports Eagle Eyes



Interactive Pet Camera



YDS CAMERA MODULE

your best camera partner

Camera Module Pinout Definition Reference Chart

OmniVision	Sony	Samsung	On-Semi	Aptina	Himax	GalaxyCore	PixArt	SmartSens	Sensors
Pin Signal		Description							
DGND	GND	ground for digital circuit							
AGND		ground for analog circuit							
PCLK	DCK	DVP PCLK output							
XCLR	PWDN	XSHUTDOWN	STANDBY	power down active high with internal pull-down resistor					
MCLK	XVCLK	XCLK	INCK	system input clock					
RESET	RST	reset active low with internal pull-up resistor							
NC	NULL	no connect							
SDA	SIO_D	SIOD	SCCB data						
SCL	SIO_C	SIOC	SCCB input clock						
VSYNC	XVS	FSYNC	DVP VSYNC output						
HREF	XHS	DVP HREF output							
DOVDD	power for I/O circuit								
AFVDD	power for VCM circuit								
AVDD	power for analog circuit								
DVDD	power for digital circuit								
STROBE	FSTROBE	strobe output							
FSIN	synchronize the VSYNC signal from the other sensor								
SID	SCCB last bit ID input								
ILPWM	mechanical shutter output indicator								
FREX	frame exposure / mechanical shutter								
GPIO	general purpose inputs								
SLASEL	I2C slave address select								
AFEN	CEN chip enable active high on VCM driver IC								
MIPI Interface									
MDN0	DN0	MD0N	DATA_N	DMO1N	MIPI 1st data lane negative output				
MDP0	DP0	MD0P	DATA_P	DMO1P	MIPI 1st data lane positive output				
MDN1	DN1	MD1N	DATA2_N	DMO2N	MIPI 2nd data lane negative output				
MDP1	DP1	MD1P	DATA2_P	DMO2P	MIPI 2nd data lane positive output				
MDN2	DN2	MD2N	DATA3_N	DMO3N	MIPI 3rd data lane negative output				
MDP2	DP2	MD2P	DATA3_P	DMO3P	MIPI 3rd data lane positive output				
MDN3	DN3	MD3N	DATA4_N	DMO4N	MIPI 4th data lane negative output				
MDP3	DP3	MD3P	DATA4_P	DMO4P	MIPI 4th data lane positive output				
MCN	CLKN	CLK_N	DCKN	MIPI clock negative output					
MCP	CLKP	CLK_P	DCKN	MIPI clock positive output					
DVP Parallel Interface									
D0	DO0	Y0	DVP data output port 0						
D1	DO1	Y1	DVP data output port 1						
D2	DO2	Y2	DVP data output port 2						
D3	DO3	Y3	DVP data output port 3						
D4	DO4	Y4	DVP data output port 4						
D5	DO5	Y5	DVP data output port 5						
D6	DO6	Y6	DVP data output port 6						
D7	DO7	Y7	DVP data output port 7						
D8	DO8	Y8	DVP data output port 8						
D9	DO9	Y9	DVP data output port 9						
D10	DO10	Y10	DVP data output port 10						
D11	DO11	Y11	DVP data output port 11						

www.YDSCAM.com sales@ydscam.com Phone (WeChat, QQ): (+86) 177 2732 6718

All rights reserved @ YingDeShun Co. Ltd. Specifications subject to change without notice.

Camera Reliability Test

Reliability Inspection Item		Testing Method	Acceptance Criteria	
Category	Item			
Environmental	Storage Temperature	High 60°C 96 Hours	Temperature Chamber	No Abnormal Situation
		Low -20°C 96 Hours	Temperature Chamber	No Abnormal Situation
	Operation Temperature	High 60°C 24 Hours	Temperature Chamber	No Abnormal Situation
		Low -20°C 24 Hours	Temperature Chamber	No Abnormal Situation
	Humidity	60°C 80% 24 Hours	Temperature Chamber	No Abnormal Situation
	Thermal Shock	High 60°C 0.5 Hours Low -20°C 0.5 Hours Cycling in 24 Hours	Temperature Chamber	No Abnormal Situation
Physical	Drop Test (Free Falling)	Without Package 60cm	10 Times on Wood Floor	Electrically Functional
		With Package 60cm	10 Times on Wood Floor	Electrically Functional
	Vibration Test	50Hz X-Axis 2mm 30min	Vibration Table	Electrically Functional
		50Hz Y-Axis 2mm 30min	Vibration Table	Electrically Functional
		50Hz Z-Axis 2mm 30min	Vibration Table	Electrically Functional
	Cable Tensile Strength Test	Loading Weight 4 kg 60 Seconds Cycling in 24 Hours	Tensile Testing Machine	Electrically Functional
Electrical	ESD Test	Contact Discharge 2 KV	ESD Testing Machine	Electrically Functional
		Air Discharge 4 KV	ESD Testing Machine	Electrically Functional
	Aging Test	On/Off 30 Seconds Cycling in 24 Hours	Power Switch	Electrically Functional
	USB Connector	On/Off 250 Times	Plug and Unplug	Electrically Functional



Camera Inspection Standard

Inspection Item		Inspection Method	Standard of Inspection		
Category	Item				
Appearance	FPC/ PCB	Color	The Naked Eye	Major Difference is Not Allowed.	
		Be Torn/Chopped	The Naked Eye	Copper Crack Exposure is Not Allowed.	
		Marking	The Naked Eye	Clear, Recognizable (Within 30cm Distance)	
	Holder	Scratches	The Naked Eye	The Inside Crack Exposure is Not Allowed	
		Gap	The Naked Eye	Meet the Height Standard	
		Screw	The Naked Eye	Make Sure Screws Are Presented (If Any)	
		Damage	The Naked Eye	The Inside Crack Exposure is Not Allowed	
	Lens	Scratch	The Naked Eye	No Effect On Resolution Standard	
		Contamination	The Naked Eye	No Effect On Resolution Standard	
		Oil Film	The Naked Eye	No Effect On Resolution Standard	
		Cover Tape	The Naked Eye	No Issue On Appearance.	
	Function	Image	No Communication	Test Board	Not Allowed
			Bright Pixel	Black Board	Not Allowed In the Image Center
Dark Pixel			White board	Not Allowed In the Image Center	
Blurry			The Naked Eye	Not Allowed	
No Image			The Naked Eye	Not Allowed	
Vertical Line			The Naked Eye	Not Allowed	
Horizontal Line			The Naked Eye	Not Allowed	
Light Leakage			The Naked Eye	Not Allowed	
Blinking Image			The Naked Eye	Not Allowed	
Bruise			Inspection Jig	Not Allowed	
Resolution			Chart	Follows Outgoing Inspection Chart Standard	
Color			The Naked Eye	No Issue	
Noise			The Naked Eye	Not Allowed	
Corner Dark			The Naked Eye	Less Than 100px By 100px	
Color Resolution			The Naked Eye	No Issue	
Dimension	Height	The Naked Eye	Follows Approval Data Sheet		
	Width	The Naked Eye	Follows Approval Data Sheet		
	Length	The Naked Eye	Follows Approval Data Sheet		
	Overall	The Naked Eye	Follows Approval Data Sheet		

YDSCAM Package Solutions

YDS Camera Module



Complete with Lens Protection Film



Tray with Grid and Space



Place Cameras on the Tray



YDSCAM Package Solutions

Full Tray of Cameras

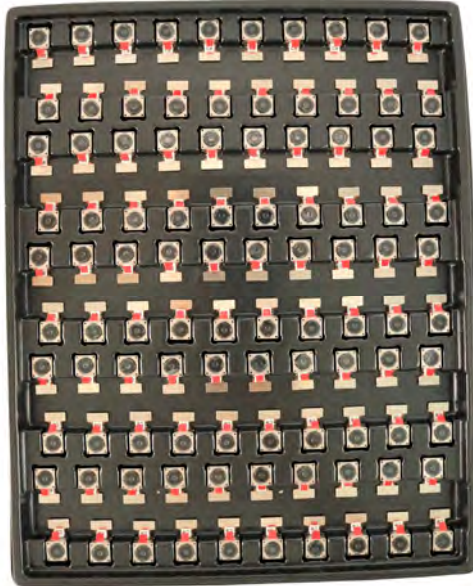

Cover Tray with Lid



Place Tray into Anti-Static Bag



Vacuum the Anti-Static Bag



YDSCAM Package Solutions

Sealed Vacuum Anti-Static Bag with Labels

1. Model and Description 2. Quantity 3. Manufacturing Date Code 4. Caution



YDSCAM Package Solutions

Place Foam Sheets Between Tray Bags



Foam Sheets are Larger Than Trays



Place Foam Sheets and Trays into Box



Foam Sheets are Tightly Fitting in Box



Seal the Carbon Box



Label the Carbon Shipping Box





YDSCAM Package Solutions

USB Camera Module

Complete with Lens Protection Film



Place Camera Sample into Anti-Static Bag

Place USB Cameras into Tray



Seal the Tray with Anti-Static Bag

Label the Carbon Shipping Box



YDSCAM Package Solutions

Place Camera Sample into Anti-Static Bag



Place Connectors into Anti-Static Bag



Label the Sample Bags



Place Connectors into Reel



Place Samples into the Carbon Box



Place Connectors into the Carbon Box





YDS CAMERA MODULE

your best camera partner

Company YDSCAM

YingDeShun Co. Ltd. (YDS) was established in 2017, a next-generation technology driven manufacturer specialized in research, design, and produce of audio and video products. YDS is occupying 20,000 square feet automated plants with 100 employees of annual throughput 30,000,000 units cameras.

YDS provides OEM, ODM design, contract manufacturing, and builds the camera products. You may provide the requirements to us, even with a hand draft, our sales and engineering work together to meet your needs. We consider ourselves your last-term partner in developing practical and innovative solutions.

Our team covers everything from initial concept development to mass produced product. YDS specializes in customized camera design, raw material, electronic engineering, firmware/software development, product testing, and packing design. Our experienced strategic supply systems offer a robust and dependable manufacturing capacity for orders of various sizes.

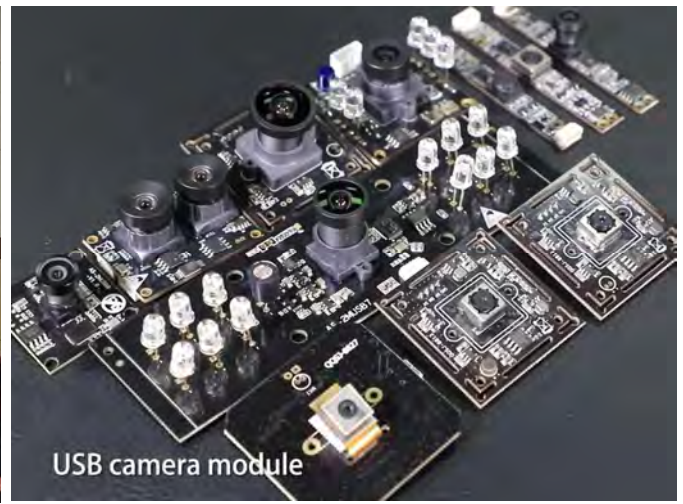

Limited Warranty

YDS provides the following limited warranty if you purchased the Product(s) directly from YDS company or from YDS's website www.YDSCAM.com. Product(s) purchased from other sellers or sources are not covered by this Limited Warranty. YDS guarantees that the Product(s) will be free from defects in materials and workmanship under normal use for a period of one (1) year from the date you receive the product ("Warranty Period").

For all Product(s) that contain or develop material defects in materials or workmanship during the Warranty Period, YDS will, at its sole option, either: (i) repair the Product(s); (ii) replace the Product(s) with a new or refurbished Product(s) (replacement Product(s) being of identical model or functional equivalent); or (iii) provide you a refund of the price you paid for the Product(s).

This Limited Warranty of YDS is solely limited to repair and/or replacement on the terms set forth above. YDS is not reliable or responsible for any subsequent events.



www.YDSCAM.com sales@ydscam.com Phone (WeChat, QQ): (+86) 177 2732 6718

All rights reserved @ YingDeShun Co. Ltd. Specifications subject to change without notice.



YDS CAMERA MODULE

your best camera partner

YDS Strength

Powerful Factory



Professional Service



Promised Delivery



www.YDSCAM.com sales@ydscam.com Phone (WeChat, QQ): (+86) 177 2732 6718

All rights reserved @ YingDeShun Co. Ltd. Specifications subject to change without notice.